

**TOWN AND COUNTRY PLANNING ACT 1990**  
**THE LAND AT POTTER BROW ROAD, BAILDON**  
**TREE PRESERVATION ORDER 2018**

The City of Bradford Metropolitan District Council in exercise of the powers conferred on them by Section 198 of the Town and Country Planning Act 1990 make the following Order:-

**Citation**

1. This Order may be cited as The Land at Potter Brow Road, Baildon Tree Preservation Order 2018.

**Interpretation**

2. (1) In this Order "the authority" means City of Bradford Metropolitan District Council.
- (2) In this Order any reference to a numbered section is a reference to the section so numbered in the Town and Country Planning Act 1990 and any reference to a numbered regulation is a reference to the regulation so numbered in the Town and Country Planning Act (Tree Preservation) (England) Regulations 2012.

**Effect**

3. (1) Subject to article 4, this Order takes effect provisionally on the date on which it is made.
- (2) Without prejudice to subsection (7) of section 198 (power to make tree preservation orders) or subsection (1) of section 200 (tree preservation orders: Forestry Commissioners) and, subject to the exception in regulation 14, no person shall:-
  - (a) cut down, top, lop, uproot, wilfully damage, or wilfully destroy; or
  - (b) cause or permit the cutting down, topping, lopping, wilful damage or wilful destruction of,

any tree specified in the Schedule to this Order except with the written consent of the authority in accordance with regulations 16 and 17, or of the Secretary of State in accordance with regulation 23 and, where such consent is given subject to conditions, in accordance with those conditions.

**Application to trees to be planted pursuant to a condition**

4. In relation to any tree identified in the first column of the Schedule by the letter "C", being a tree to be planted pursuant to a condition imposed under paragraph (a) of section 197 (planning permission to include appropriate provision for

TREE PRESERVATION ORDER 18/00009/W  
LAND AT POTTER BROW ROAD, BAILDON

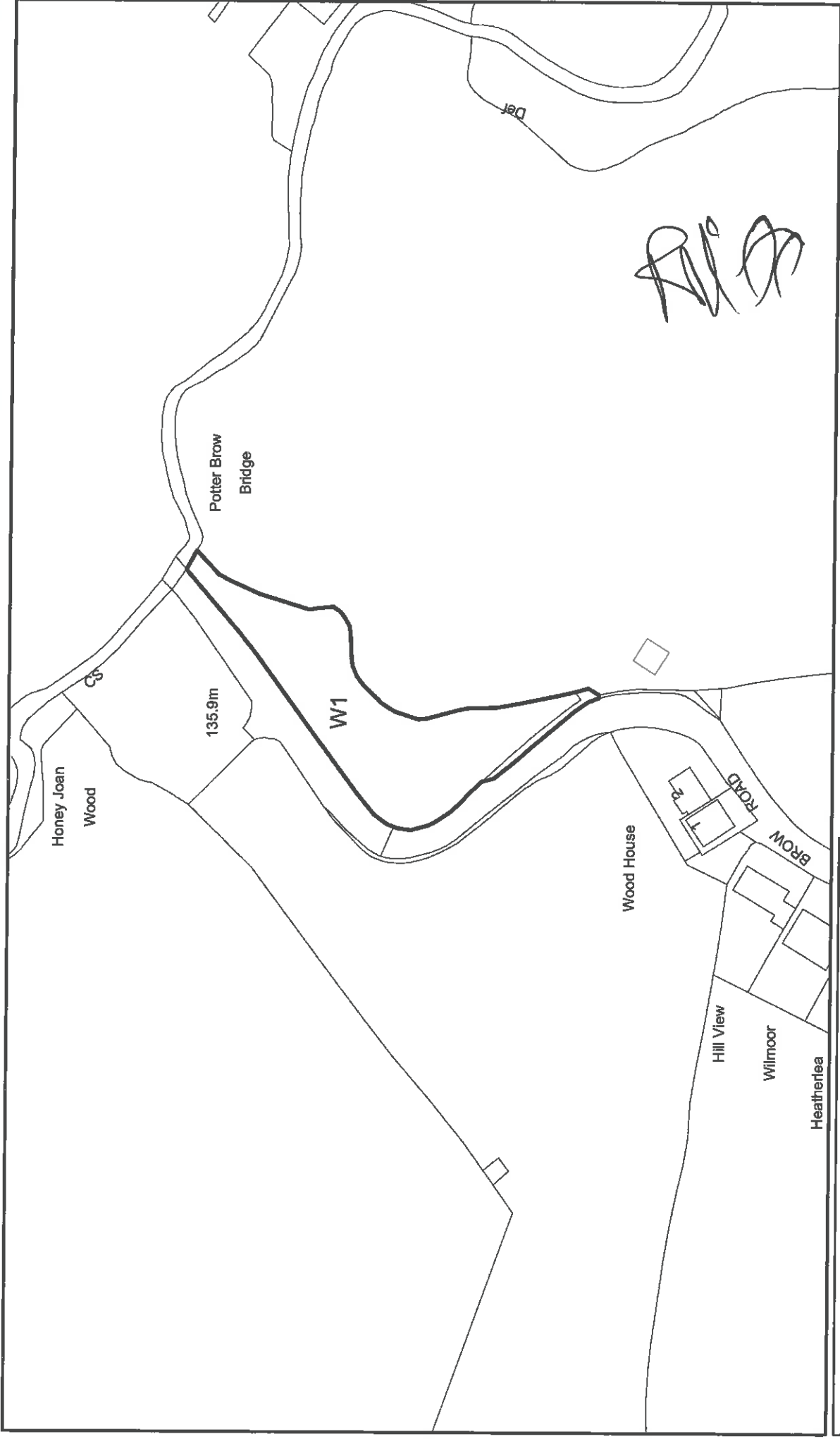

TREE PRESERVATION ORDER  
18/00009/W  
LAND AT POTTER BROW ROAD  
BAILDON

DEPARTMENT OF PLACE  
Britannia House  
Bradford  
BD1 1HX

OS Ref : SE1541  
Reproduced from the Ordnance Survey map with  
the sanction of HM Stationery Office  
Crown Copyright reserved  
LA076120

Scale 1: 1,250

preservation and planting of trees), this Order take effect as from the time when the tree is planted.

Dated this 14<sup>th</sup> day of June 2018.

98883

**EXECUTED AS A DEED** by affixing  
**THE COMMON SEAL** of **THE CITY**  
**OF BRADFORD METROPOLITAN**  
**DISTRICT COUNCIL** in the presence of:-

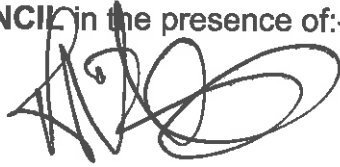

Authorised by the Interim City Solicitor



### CONFIRMATION OF ORDER

This Order was confirmed by the City of Bradford Metropolitan District Council without modification on the 30<sup>th</sup> day of August 2018.

OR

~~The Order was confirmed by the City of Bradford Metropolitan District Council subject to the modification indicated by \_\_\_\_\_ on the \_\_\_\_\_ day of \_\_\_\_\_~~

**EXECUTED AS A DEED** by affixing  
**THE COMMON SEAL** of **THE CITY**  
**OF BRADFORD METROPOLITAN**  
**DISTRICT COUNCIL** in the presence of:-

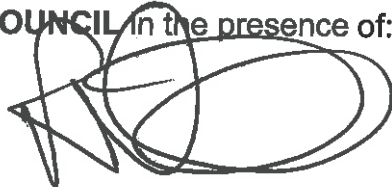

Authorised by the Interim City Solicitor



99109

### DECISION NOT TO CONFIRM

A decision not to confirm this Order was taken by the City of Bradford Metropolitan District Council on the \_\_\_\_\_ day of \_\_\_\_\_

**EXECUTED AS A DEED** by affixing  
**THE COMMON SEAL** of **THE CITY**  
**OF BRADFORD METROPOLITAN**  
**DISTRICT COUNCIL** in the presence of:-

Authorised by the Interim City Solicitor



## SCHEDULE

### Specification of Trees

#### Trees specified individually

(encircled in black on the map)

Reference on map	Description	Situation
NONE		

#### Trees specified by reference to an area

(within a dotted black line on the map)

Reference on map	Description	Situation
NONE		

#### Groups of trees

(within a broken black line on the map)

Reference on map	Description	Situation
NONE		

#### Woodlands

(within a continuous black line on the map)

Reference on map	Description	Situation
W1	ALL TREES OF WHATEVER SPECIES	415103, 441327